

Criterion B Solution Overview

Design Overview

Inputs / Outputs

//Created before the program is made, therefore, might be some changes

Login/Join UI

Input	Data Type	Example
Register as	ComboBox	Patient
Assigned Patient	ComboBox	Mr. John Smith
Username	String	peemjatabut
Password	String	abc1234
Suffix	String	Mr.
First Name	String	John
Last Name	String	Smith
Sex	Radio Button	Male
Chronic Disease	String	Parkinson's Disease
setUsername	String	peemjatabut
setPassword	String	abc1234
cfmPassword	String	abc1234
Output	Data Type	Example
Register as	String	Patient
Username	String	peemjatabut
Password	String	abc1234
Patient's chronic disease	String	Parkinson's disease
Name	String	Mr. John Smith
Assigned Patient	String	Mr. John Smith
Assigned Doctor	String	Prof.Dr. Roongroj Bhidayasiri
Sex	String	Male

Doctor UI

Input	Data Type	Example
Brand Name	String	Madopar
Brief Use	String	“Increase dopamine level”
Dose	Double	12.5
Quantity per pack	Integer	20
Dosage Form	ComboBox	Oral
First Name	String	Rachata
Last Name	String	Jatabut
Output	Data Type	Example
Brand Name	String	Madopar
Brief Use	String	Increase dopamine level
Dose	Double	12.5
Quantity per pack	Integer	50
Dosage Form	String	Oral

Rx UI

Input	Data Type	Example
Brand	ComboBox	Madopar
Time	ComboBox	11:00 PM
Dosage	ComboBox	1/2
Output	Data Type	Example
Time	String	11:00 PM
Brand	String	Madopar
Dosage	String	1/2
Total Dosage	Double	19.5
Observation	String	Hallucinate after taking madopar

Patient UI

Input	Data Type	Example
Month	ComboBox	January
Date	ComboBox	1
Year	String	2018
Observation	String	Hallucinate after taking madopar
Output	Data Type	Example
Time	String	11:00 PM
Brand	String	Madopar
Dosage	String	1/2
Patient Name	String	Mr. John Smith
Assigned Doctor	String	Prof.Dr. Roongroj Bhidayasiri
Sickness	String	Parkinson's Disease
Estimated days until next order	Integer	14

Class Diagram

Chronological Development

Login/Join

Join UI

Get patient names from the users database

Add to indexes in the assigned patient combo box

If login as Doctor then disable Chronic disease tab.. If patient disable Assigned patient tab

Get String from text fields, combo boxes, and Radio Button

Loop for in the users database and compare the username password inputted with the existing username passwords in the database.

If it is repeated, then Message dialog to notify that it is repeated

Else (not repeated)

Add information into users Database

Login

Get username and password from textfields and get login as from combo box

loop For in database

If !match then pop up "This username does not exist"

If match

Check the password of that array position
If password match then check if the login as match
Then open the appropriate UI for that user (doctor open doctor UI)

Doctor UI

Patient

On tab click
Get all users that are patient from the users database
Display on the patient TBL

Search

Get First name and last name from search text fields
On search click
Run in the users database
If !match
Pop up "not exist"
If match. Get Rx info of that patient from Rx database of the matching name
Display on prescription
On click: Edit list of searched patient .. opens RxUI

Medicines

On tab click: Display medicine database on medicine TBL
Get information from the textfields and combobox
On click: If textfield.isempty
Pop up: "please to complete"
If complete then add to medicine database.
Refresh table (display medicine database)

RxUI

Add medicine

Get medicine brand from medicine database
Add to element of brand combo box
Get name from the searched patient and display on the label
Get time from combo box
Get dose from combo box
Dose * get dosage of that brand from medicine database
Sum of all doses and display in total dose label.
On click: Add
Display on prescription TBL

On click: Assign Add to Rx info of that patient

Observation

Get text and date from observation from patient UI
Send it to doctor UI
Display text on doctor's observation Textfield
Display date on date label

Patient UI

Schedule

Get patient name assigned doctor and sickness.
Get Rx information of the login user
First medicine
Get time and dose
Loop for all medicine
Display it in the time textfield according to the time matched
//For example: Madopar 11:00am $\frac{1}{2}$ 5:00pm $\frac{3}{4}$
Time 11:00am dose $\frac{1}{2}$ -> display on 11am Text field as "Madopar $\frac{1}{2}$ "
Time 5:00pm dose $\frac{3}{4}$ -> display on 5pm text field as "Madopar $\frac{3}{4}$ "
End loop
And add under the preceding line

Information

Get month date and year
Get text from the observation text field from patient UI
Display on doctor's text field
?
Display Java message dialog showing written instructions and explanations of the UI.

Testing plan

Inputs	Normal Data	Border Data	Wrong type	Extreme	Response
First name	John	Blank text field	Integer or double	30 characters or more	Message dialog and reset if click ok. Do not add to database until it is correct.
Last name	Smith	Blank text field	Integer or double	30 characters or more	Message dialog and reset if click ok. Do not add to database until it is correct.
Chronic disease	Parkinson's disease	Blank text field	Integer or double	30 characters or more	Message dialog and reset if click ok. Do not add to database until it is correct.
Username	peemjatabut1	Blank text field	Numbers only	30 characters or more	Message dialog and reset if click ok. Do not add to database until it is correct
Password	peem9778	Blank text field	Only number or only text	30 characters or more	Message to remind the requirements for the password. Do not add to database until it is correct
Cfrm password	peem9778 (the same as password)	Misspell or blank text field	All numbers	30 characters or more	Message saying that the password confirmed doesn't match. Do not add to database until it is correct.
Suffix	Mr. Ms. Dr.	Blank text field	Numbers	More than 10 characters	Message dialog and reset if click ok. Do not add to database until it is correct
Brand Name	Madopar	Blank text field	Numbers only	More than 20 characters	Message dialog for revision. Do not add to database until it is correct

Brief Use	Increase dopamine level	Blank text field	Numbers only	More than 50 characters	Message dialog to reduce word or input brief use.
Dose	12.5 or 100	Blank text fields	Not integer or double	More than 10 characters	Message dialog to revise the dose or input the dose.
Quantity per pack	20	Blank text fields	Not integer or double	More than 10 characters	Message dialog to revise the dose or input the dose.

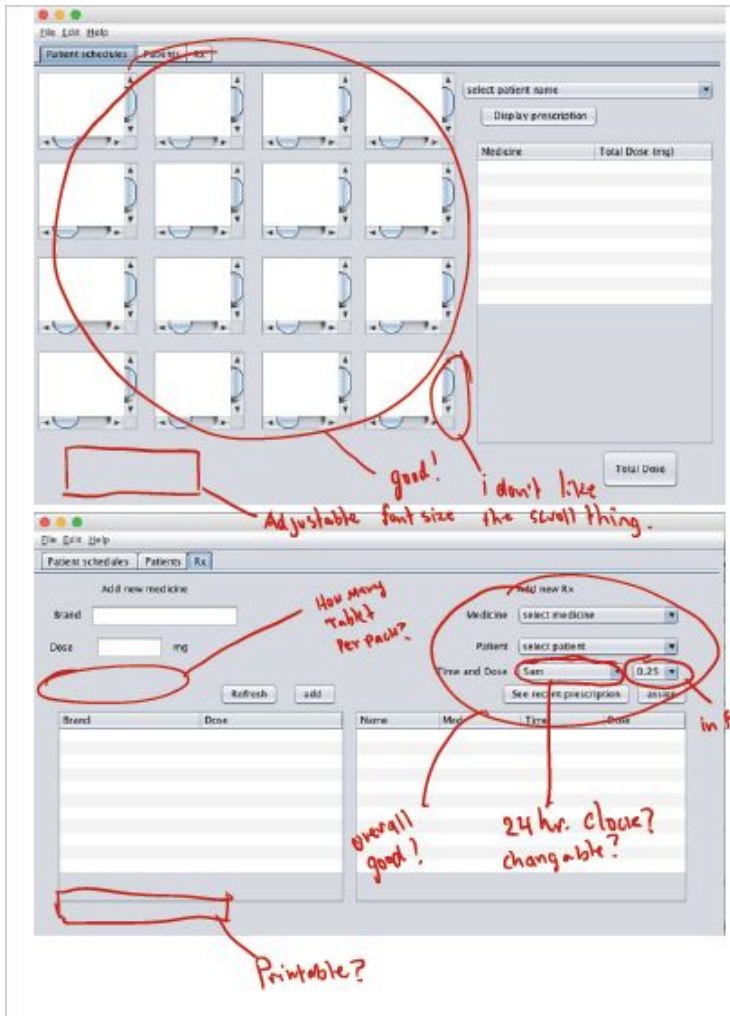

Clients' Annotation on Design

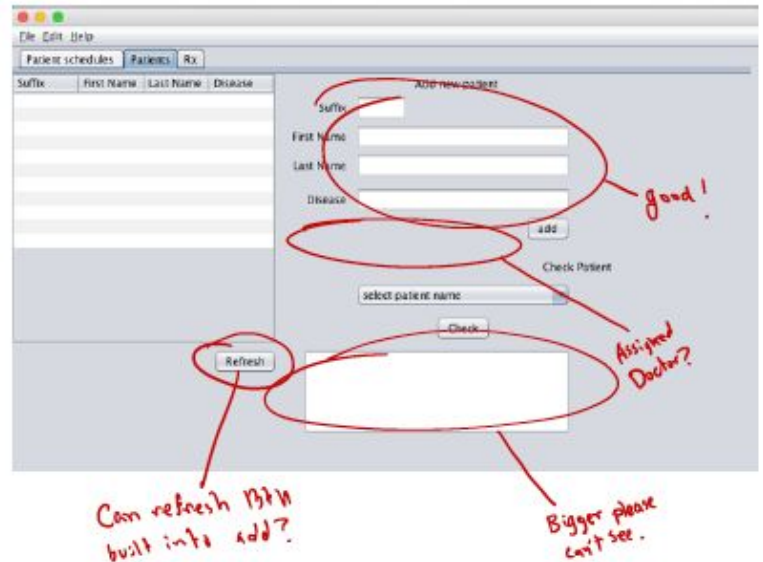

frame

